

APPLICATION: Cooling Systems

Application: Liquid/Solid
Cooling systems

Why process?

For application with open cooling tower, the direct air water contact is used for cooling, the latent evaporation heat being used to extract the calories. But the cooling tower is also a perfect air washing system trapping the surrounding dirt.

The system collects both suspended particles and biological pollution.

When using river or drill water sludge could slowly plug the exchanger system and sand could introduce early wear of control and feed devices (valves, gauges etc. ...).

For use with seawater in addition to sand some "dwarf" shells are also introduced into the system and will grow in the hot at aerated system water.

How to process?

With appropriate filtration based on an automatic controlled equipment suitable for suspended materials:

either a cyclone separator
or an automatic controlled self-cleaning filter.

The choice should be made considering the suspended pollution in the processed fluid.

Either using a complementary biocide treatment made either by chemical injection or U.V. treatment but mostly a combination of both

Hereafter two examples of processing equipment without mowing part frequently used for cooling system filtration.

Fiche 03_09 "LST"

Fiche 02-02 "vertical hydrocyclone"

Fiche 02_03 "Horizontal hydrocyclone"

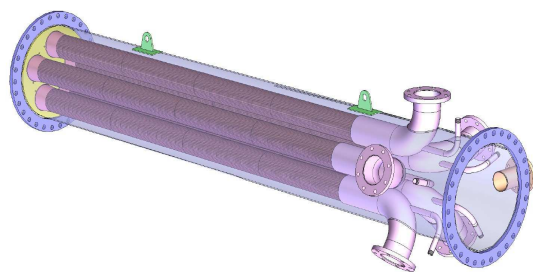

Minimum required data for enquiry:

Type of fluid and application.
Nominal and design pressure.

Nominal and design flow capacity
Required micron rating.

LEFCO SA 53 Av Paul Langevin 51530 MARDEUIL, France
Téléphone : 33 (0)3 26 55 56 70 // Télécopie : 33 (0)3 62 02 20 45
Courriel: info@lefc.fr
Site : www.lefc.fr
SA capital 128 057 Euro // Siret 095 650 487 000 10 // NAF 2829B

