

Pertes de Charge Encombrements Cyclones SLV

Séparation : Liquide/Solide
Matériel : FILTRE
Média : permanent
TECHNIQUE

SERIE "SLV" POUR LIQUIDES

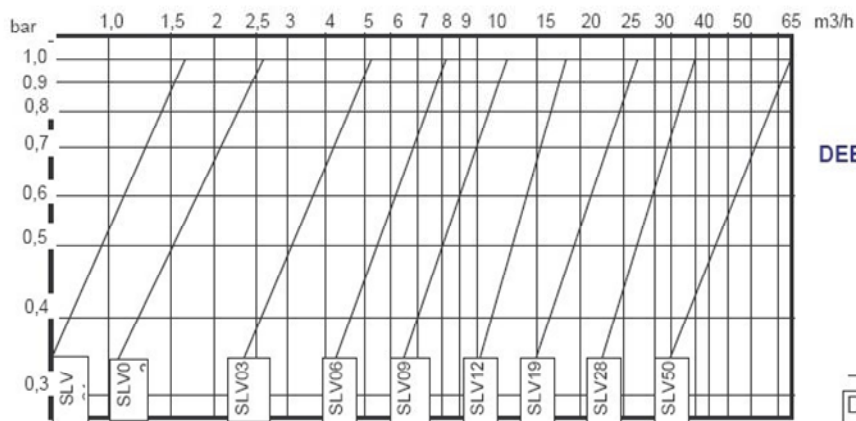

DEBITS/PERTES DE CHARGE

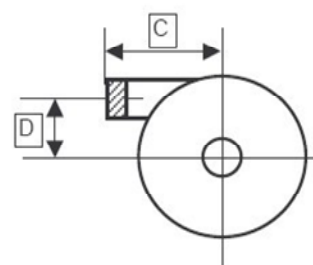

SPECIFICATIONS GENERALES ET DIMENSIONS

MODELE	Débit m3/h		Débit l/mn		ΔP bar		Taille maxi particules
	mini	maxi	mini	maxi	mini	maxi	
SLV 01	0.7	1.6	12	27	0.47	0.95	6 mm
SLV 02	1.2	2.6	20	43	0.35	1	6 mm
SLV 03	2.8	4.6	45	77	0.45	0.85	6 mm
SLV 06	4.7	7.6	78	127	0.4	0.9	6 mm
SLV 09	6.6	11.2	110	187	0.38	0.86	9 mm
SLV 12	10.5	16.2	185	270	0.35	0.84	9 mm
SLV 19	14.5	23.8	242	397	0.34	0.83	9 mm
SLV 28	21.5	34.5	358	585	0.38	0.8	9 mm
SLV 50	33.5	65	558	1083	0.35	0.85	9 mm

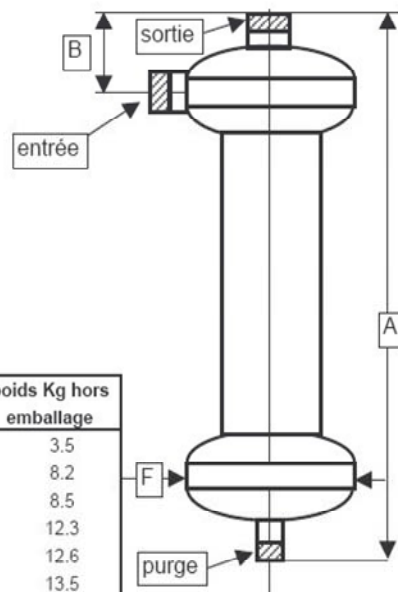

MODELE	entrée et sortie	A	B	C	D	F	drain	poids Kg hors emballage
SLV 01	filet. 3/8"	410	70	90	35	102	3/4"	3.5
SLV 02	filet. 1/2"	518	111	112	60	168	3/4"	8.2
SLV 03	filet. 3/4"	521	111	114	60	168	3/4"	8.5
SLV 06	filet. 1"	759	111	114	55	168	3/4"	12.3
SLV 09	filet. 1"1/4	759	111	114	50	168	3/4"	12.6
SLV 12	filet. 1"1/2	759	111	118	50	168	3/4"	13.5
SLV 19	filet. 2"	838	119	140	70	219	3/4"	26.2
SLV 28	bride dn65	850	125	185	65	219	3/4"	33
SLV 50	bride dn80	995	162	210	75	273	3/4"	48